



DEVELOPER: CHRIS JONES 575-706-2967  
 THEOUTLAWESTATES.COM



| Lot               | Price | Lot     | Price | Lot     | Price     | Lot     | Price     | Lot | Price     |
|-------------------|-------|---------|-------|---------|-----------|---------|-----------|-----|-----------|
| 1A                | SOLD  | 48A     | SOLD  | 18B     | SOLD      | 59B     | SOLD      | 10D | SOLD      |
| 2-4A              | SOLD  | 49A     | SOLD  | 19B     | SOLD      | 60B     | SOLD      | 11D | SOLD      |
| 5A                | SOLD  | 50A     | SOLD  | 20B     | SOLD      | 61B     | SOLD      | 12D | SOLD      |
| 6A                | SOLD  | 51A     | SOLD  | 21B     | SOLD      | 62B     | SOLD      | 13D | SOLD      |
| 7A                | SOLD  | 52A     | SOLD  | 22B-23B | SOLD      | 63B     | SOLD      | 14D | SOLD      |
| 8A                | SOLD  | 53A     | SOLD  | 24B     | SOLD      | 64B     | SOLD      | 15D | \$275,000 |
| 9A                | SOLD  | 54A     | SOLD  | 25B     | SOLD      | 65B     | SOLD      | 16D | \$225,000 |
| 10A               | SOLD  | 55A     | SOLD  | 26B     | SOLD      | 66B     | SOLD      | 17D | \$225,000 |
| 11A               | SOLD  | 56A     | SOLD  | 27B     | SOLD      | 67B     | SOLD      | 18D | \$225,000 |
| 12A-15A & 1C      | SOLD  | 57A     | SOLD  | 28B     | SOLD      | 68B     | SOLD      | 19D | \$225,000 |
| 16A               | SOLD  | 58A     | SOLD  | 29B     | SOLD      | 69B     | SOLD      | 20D | \$225,000 |
| 17A               | SOLD  | 59A     | SOLD  | 30B     | SOLD      | 70B     | SOLD      | 21D | SOLD      |
| 18A-19A & 14C     | SOLD  | 60A     | SOLD  | 31B     | SOLD      | 71B     | SOLD      | 22D | \$225,000 |
| 20A               | SOLD  | 61A     | SOLD  | 32B     | SOLD      | 72B     | SOLD      | 23D | \$225,000 |
| 21A               | SOLD  | 62A     | SOLD  | 33B     | SOLD      | 73B     | SOLD      | 24D | HOLD      |
| 28A-30A SPORTS CT |       | 63A     | SOLD  | 34B     | SOLD      | 29C     | SOLD      | 25D | HOLD      |
| 31A               | SOLD  | 64A     | SOLD  | 35B     | SOLD      | 30C-1   | SOLD      | 26D | \$275,000 |
| 32A               | SOLD  | 65A     | SOLD  | 36B     | SOLD      | 32C-1   | SOLD      | 27D | SOLD      |
| 33A               | SOLD  | 66-68A  | SOLD  | 37B     | SOLD      | 34C     | SOLD      | 28D | SOLD      |
| 34A               | SOLD  | 69A     | SOLD  | 38B     | SOLD      | 35C     | SOLD      | 29D | SOLD      |
| 35A               | SOLD  | 70-71A  | SOLD  | 39B     | SOLD      | 36C     | SOLD      | 30D | SOLD      |
| 36A               | SOLD  | 72A     | SOLD  | 40B     | SOLD      | 37C     | SOLD      | 31D | SOLD      |
| 37A               | SOLD  | 73A     | SOLD  | 41B     | SOLD      | 38C     | SOLD      | 32D | SOLD      |
| 38A               | SOLD  | 74A     | SOLD  | 42B     | SOLD      | 39C-40C | SOLD      | 33D | SOLD      |
| 39A               | SOLD  | 75A     | SOLD  | 43B     | SOLD      | 41C     | \$125,000 | 34D | SOLD      |
| 40A               | SOLD  | 76A     | SOLD  | 44B     | SOLD      | 42C     | SOLD      | 35D | \$275,000 |
| 42A-1             | SOLD  | 1B-1    | SOLD  | 45B     | SOLD      | 43C     | SOLD      | 36D | \$275,000 |
| 42A-2             | SOLD  | 3B-1    | SOLD  | 46B     | SOLD      | 44C     | \$150,000 | 37D | \$275,000 |
| 42A-3             | SOLD  | 5B-1    | SOLD  | 47B     | SOLD      | 45C-1   | SOLD      | 38D | SOLD      |
| 43A-1             | SOLD  | 7B-1    | SOLD  | 48B     | SOLD      | 46C-1   | \$150,000 | 39D | SOLD      |
| 43A-2             | SOLD  | 9B-1    | SOLD  | 49B     | SOLD      | 1D      | \$225,000 | 40D | SOLD      |
| 43A-3             | SOLD  | 11B     | SOLD  | 50B     | SOLD      | 2D      | \$225,000 | 41D | SOLD      |
| 44A               | SOLD  | 12B     | SOLD  | 51B     | \$150,000 | 3D      | \$225,000 |     |           |
| 45A               | SOLD  | 13B     | SOLD  | 52B     | \$150,000 | 4D      | \$225,000 |     |           |
| 46A               | SOLD  | 14B-16B | SOLD  | 53-54B  | SOLD      | 5D      | \$225,000 |     |           |
| 47A               | SOLD  | 17B     | SOLD  | 55B     | SOLD      | 6D      | SOLD      |     |           |
|                   |       |         |       | 56B     | SOLD      | 7D      | SOLD      |     |           |
|                   |       |         |       | 57B     | SOLD      | 8D      | \$250,000 |     |           |
|                   |       |         |       | 58B     | SOLD      | 9D      | SOLD      |     |           |



SCOTT MILLER  
 QUALIFYING BROKER  
 575-937-3166

REVISED 1/04/2024

# 1 TO 3.5 ACRE GOLF COURSE HOME SITES

INCLUDES FULL MEMBERSHIP TO ALTO LAKES GOLF & COUNTRY CLUB



The Outlaw at Alto Golf Estates is an enclave of over 235 estate sized home sites--150 on the golf course. Each lot includes a full membership to Alto Lakes Golf & Country Club, valued at \$30,000 at no additional cost. Live The Outlaw Lifestyle surrounded by nature's beauty and serene atmosphere. Enjoy the country club with all its amenities and recreational benefits, including 36 holes of golf! The Outlaw is just minutes away from the town of Ruidoso, Spencer Theater, and the airport. Just imagine, finding the perfect site for your next home, second home, or vacation home. See for yourself-- The Outlaw is located a short golf cart drive east and adjacent to Alto Lakes Golf & Country Club.

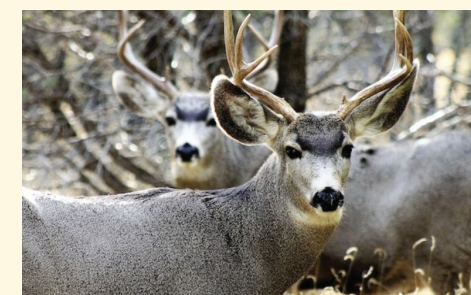

SCOTT MILLER 575-937-3166

THEOUTLAWESTATES.COM



# LEGEND

Information is deemed reliable but not guaranteed.

**A** 1.234 **AVAILABLE**  
Lot Size (Acres)

**B** 1.234 **AVAILABLE**  
Lot Size (Acres)

**C** 1.234 **AVAILABLE**  
Lot Size (Acres)

FADED NUMBERS INDICATES SOLD

**A** **B** **C**

**D** Future Phase

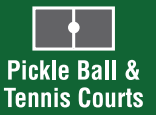

North Entrance

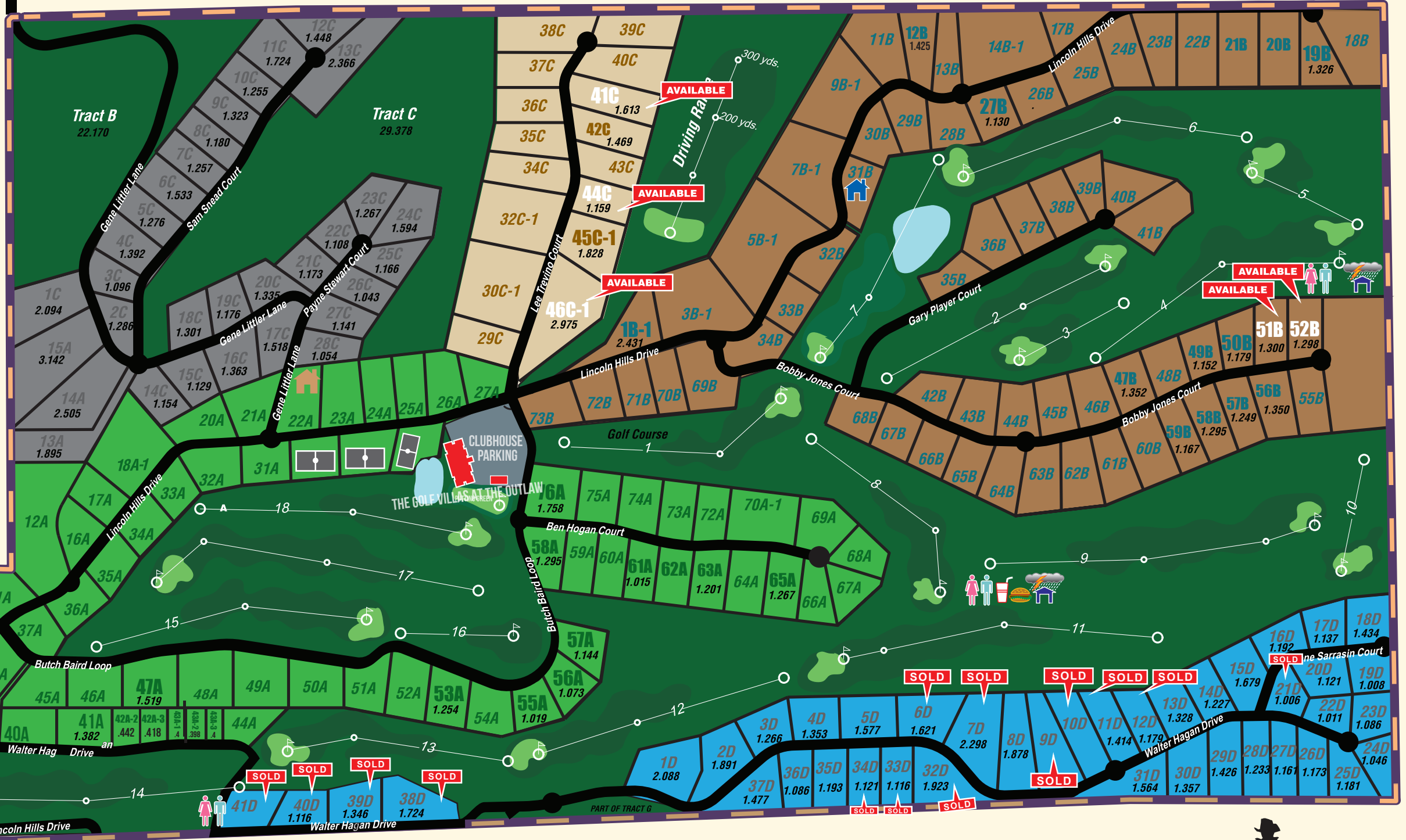

South Entrance



# 1 TO 3.5 ACRE GOLF COURSE HOME SITES

INCLUDES FULL MEMBERSHIP TO ALTO LAKES GOLF & COUNTRY CLUB

SCOTT MILLER 575-937-3166

THEOUTLAWESTATES.COM

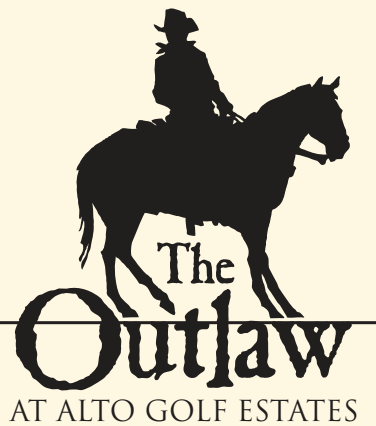

AT ALTO GOLF ESTATES